



Project: \_\_\_\_\_  
 Location: \_\_\_\_\_  
 Item #: \_\_\_\_\_  
 Quantity: \_\_\_\_\_

## Back Bar Cooler

### VBB MODELS —

Black Vinyl on Steel Exterior Finish with  
 Stainless Steel Countertop and Interior Floor.  
 Galvanized Steel Interior Ceiling and Walls.

**VBB-48-B-B-1**

**VBB-72-B-B-1**



**VBB-48-B-B-1 Illustrated**

### Standard Features (all models)

- Available In Even Increments of 48" and 72" Widths
- Self-Contained, Capillary Tube Refrigeration System Uses Environmentally Friendly R-134a Refrigerant
- Sleek, Modern Design
- Extremely Durable, Black Vinyl On Steel Exterior with a Stainless Steel Countertop
- Heavy-Duty Reinforced Stainless Steel Floor with Galvanized Steel Walls and Ceiling
- Threshold Sills are Reinforced with Heavy Gauge Stainless Steel
- Self-Closing Doors have Replaceable One-Piece Magnetic Perimeter Gaskets
- Each Door has a Cylinder Lock, and Easy Grip Horizontal Handle
- Two Heavy-Duty Epoxy Coated Shelves are Provided Per Door Section
- Incandescent Interior Lighting with a Manual On/Off Switch
- Foamed-In Place CFC and HCFC Free Polyurethane Insulation Throughout the Cabinet
- Automatic, Non-Electric Condensate Disposal System

- High Efficiency, Quiet Running, Side-Mounted Refrigeration System
- Air Distribution System chills Product Evenly and Quickly
- Operating Temperature Range 36°F to 38°F
- One-Year Warranty on Parts and Labor and a Five-Year Warranty on the Compressor (U.S.A. Only)
- 8' Cord and Plug Set Included
- Cooling Coil Above Condensing Unit Permits Full Use of Interior Space
- Forced Air is Projected the Length of the Cabinet Across the Ceiling

### Optional Features and Accessories

- 6" Adjustable Legs
- Casters (Set of 4)
- Extra Shelves
- Stainless Steel Models Available (Exterior)
- Glass Doors

Approvals:



Victory Refrigeration specification sheets are available online at [www.victory-refrig.com](http://www.victory-refrig.com).

CHARACTERISTICS	VBB-48-B-B	VBB-72-B-B
Width, Overall	48"	72"
Depth, Overall	23 1/2"	23 1/2"
Height, Overall	34"	34"
Clear Door Width	16 7/16" x 29"	17 7/8" x 29 1/4"
Depth with Door Open 90°	41 3/8"	42 3/4"
Number of Doors	2	3
Number of Shelves	4	6
Net Capacity (cubic feet)	12.1	20.5
Cabinet Voltage	115/60/1	115/60/1
Condensing Unit Size (HP)	1/4	1/4
Total Amperes	6	6
NEMA Plug	5-15P	5-15P
Crated Dimensions	27"x 51" x 44"	27" x 75" x 44"
Gross Weight (Crated lbs.)	245	326

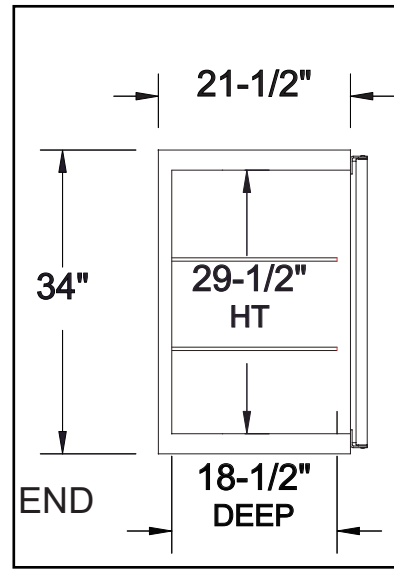

VBB-48 & VBB-72

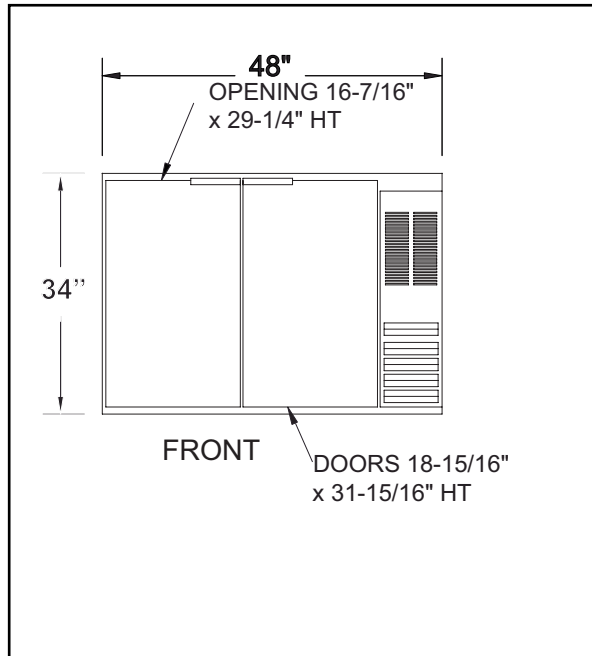

VBB-48

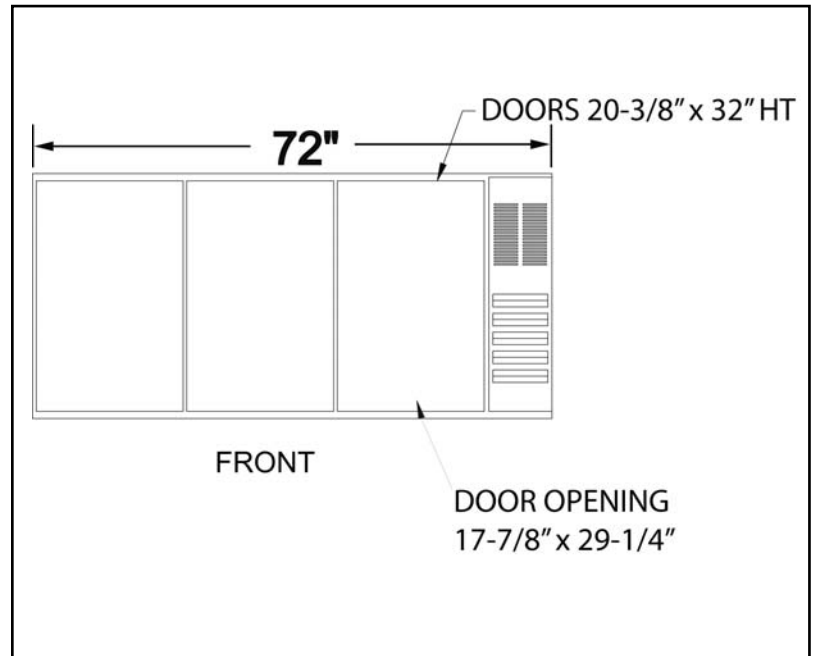

VBB-72

Continuous product development may necessitate specification changes and design without notice.



Victory participates in the KCL CADalog, the most current source of CAD symbols for foodservice designers worldwide. Symbols include standard equipment in plan, side, front and 3-D views, layered for FEDA/FCSI recommended guidelines.